

# Line pressure regulator PFR 7



## Description:

The pressure regulator PFR 7 is for the installation in line systems with large gas flows. The line pressure-regulator L1 is characterised by an accurate regulation and a large throughput.

The spring-loaded pressure-regulator works according to the principle of the force equilibrium between the adjusted spring action and the outlet pressure.

It can be equipped optionally with an inlet and an outlet gauge.

## Design:

The use of stainless steel in connection with elastomere made of viton permits the application of this pressure-regulator with aggressive media.

Through the large effective diaphragm surface, at low pressure variant, optimal controllability is guaranteed.

## Technical details:

|                      |  |
|----------------------|--|
| Material:            | brass or st. steel                                     |
| Valve seat:          | Ø 7,0  |
| Seat:                | EPDM or viton  |
| Diaphragm:           | EPDM or viton  |
| Max. Inlet pressure: | 100 bar  |
| Regulating area:     | 0,1 – 2,5 bar<br>1 – 6 bar<br>1 – 10 bar<br>1 – 16 bar |
| Operating temp.:     | -20°C to +60°C   |
| Size (WxHxD):        | 192 x 290 x 125  |
| Connections:         | inlet- G1/2 f<br>outlet- G3/4 f                        |

## Hornung Quality standard

The company Hornung is certified to

**DIN EN ISO 9001 and ISO 14001:2009.**

All single parts are manufactured, assembled and tested in house.

The finished parts are therefore under the criteria of our exact quality control with 100% final control.

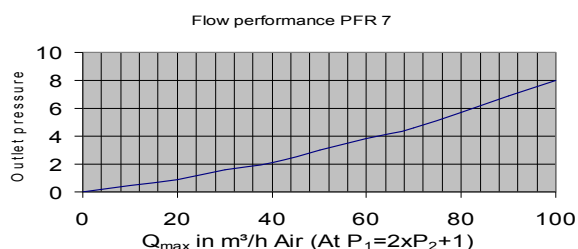
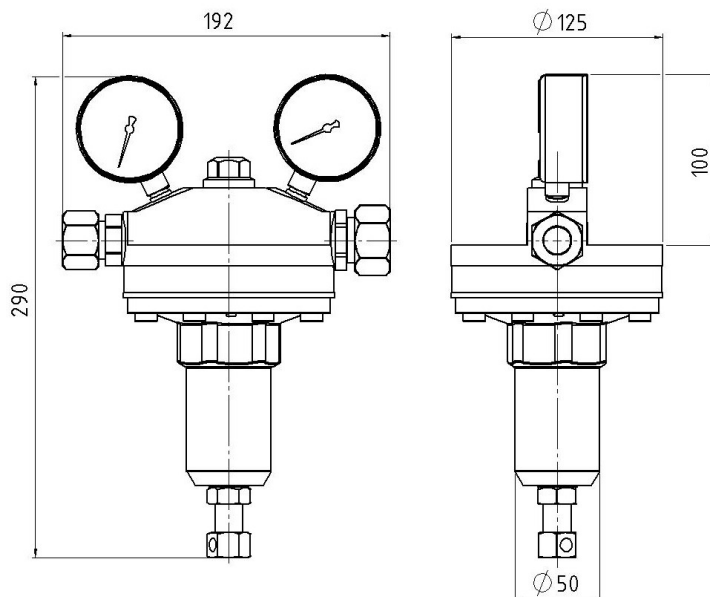

We urgently recommend the connection of a fine filter, with at least 40µ, before the pressure regulator, as well as to protect following components with suitable relief valves against unduly high pressures.

#### Accessories:

7. Gauges, Tube fittings for inlet and outlet und accessories,
8. Safety valve available on request
9. Wall mounting bracket,safety valve available on request.

#### Order details:

##### Material:

- 1 = brass  
2 = stainless steel

##### Diaphragm:

- 1 = EPDM  
2 = viton

##### Gauge:

- 1 = none  
2 = inlet and outlet gauges

##### Pressure area:

- 1 = 0,1 - 2,5 bar  
2 = 1 - 6 bar  
3 = 1 - 10 bar  
4 = 1 - 16 bar

#### Order example:

|                |       |
|----------------|-------|
| Regulator type |       |
| 41-            | PFR 7 |

|      |      |        |       |          |        |
|------|------|--------|-------|----------|--------|
| 41-  | 2    | 2      | 2     | 4        | Medium |
| Type | Mat. | Diaph. | Gauge | Pressure | Medium |